

WTS-SO WIRELESS INTERFACE WITH ASCII SERIAL OUTPUT

The WTS-SO outputs a user defined ASCII report that can contain live values and sum of up to eight WTS transmitters and forms part of the WTS modular telemetry system.

The data sent by transmitter modules can be utilized by multiple receivers such as displays, handheld readers, analog outputs, relay modules and computer interfaces. Receivers support common industrial power supplies and are available in robust IP rated enclosures with internal antennas optimized to give outstanding coverage.

The WTS-SO supports RS232 and RS485 connectivity.

The WTS Toolkit software offers a fast and simple way to configure the report format and to choose the associated transmitter modules. The reports could be just a single line giving a value to be fed into a serial display, for example, or could be a multi-line report for delivery to a printer.

FEATURES & BENEFITS

- ASCII serial output
- Serial output to printer, display, PC or PLC
- Simple configuration and calibration
- Wireless range of up to 800 m (up to 2,625 ft)

SPECIFICATIONS

POWER SUPPLY		
Power Supply Voltage – VDC		9 to 32
Supply Current at 12V (typical) – mA		100
RADIO		
Radio Type		License exempt transceiver
Radio Frequency – GHz		2.4
Transmit Power – mW		10
Range	m	Up to 800
	ft	Up to 2,625
ENVIRONMENTAL		
Operating Temperature Range	°C	-20 to 55
	°F	-4 to 131
Storage Temperature Range (no batteries)	°C	-40 to 85
	°F	-40 to 185
Maximum Humidity – %		95 non-condensing
IP Rating (excluding USB connector)		IP67/Nema4

STANDARD CONFIGURATION



WTS-SO (Shown)

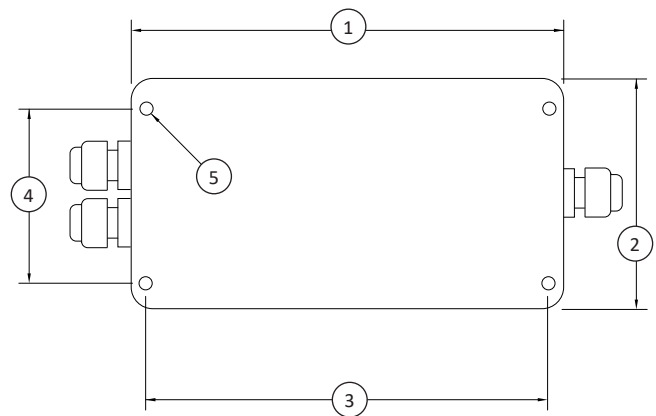

DIMENSIONS

See Drawing	Metric (mm)	U.S. (in)
(1)	164	6.46
(2)	84	3.31
(3)	148	5.83
(4)	50	1.97
(5)	Ø4.5	Ø0.18
Height	57	2.24

ELECTRICAL



U.S. dimensions and capacities are provided for conversion only. Standard products have International System of Units (SI) capacities and dimensions.