

## 1. Product description

- Wireless dimmable and CCT tunable
- No need install control wire and other controllers
- Two channels output, common anode
- External constant current driver
- Compatible with TIGI Remote, Scene Panel, Scene Switch, Sensor...
- EMC Comply with EN55015 and EN300440
- Lighting Project Solution
- CE Certificated
- 3 years warranty



T5151R

## 2. Functions

- Wireless Dimming and CCT tuning by RF-2.4G Controllers
- Can set the functions as CCT tunable or dimmable by remote
- Can set the rated current by remote
- Remote Groups control: 100 groups individually
- Scene Panel control
- Short-circuit protection
- No-load protection
- Surge protection voltage 2KV

The functions of driver are realized by TIGI controllers, please refer to TIGI controllers datasheet for more details.

## 3. Application

Residential lighting, office lighting, commercial lighting



For dimmable and tunable CCT application

## 4. Technical Data

### For Driver

Model No.	T5151R
Rated Input Voltage	220-240V
Max Input Current	0.06A
Mains Frequency	50/60Hz
Output Voltage	6-42V DC
Output Current Range	150-350mA
Dimming Range	1%-100%
Efficiency	75%
Power Factor@full load	0.5
Life Span	20'000 hrs
Mains switching cycles	> 100'000
Ambient Temperature Ta	-20°C...+45°C
Storage Temperature Ts	-20°C...+80°C
Dimension	115x41x28mm

### For RF-2.4G

Controllable Distance	30Meters without Obstacle
Protocol	TIGI RF-2.4G
Frequency Range	2402Mhz....2482Mhz
Modulation Type	GFSK
Antenna Type	Integral antenna
Antenna Quantity	1
Antenna Gain	0dBi
Operating Temperature	-20°C...+85°C

## 5. Standard

LVD	EN61347-2-13
EMI	EN55015
RED	EN300 440
RED	EN301489-1/ EN301489-3
EMS	IEC6100-3-2/IEC6100-3-3
EMS	IEC6100-4-2/ IEC6100-4-3/ IEC6100-4-4
EMS	IEC6100-4-5/ IEC6100-4-6/ IEC6100-4-8

## 6. Installation and Wiring

### 6.1 Wiring Diagram

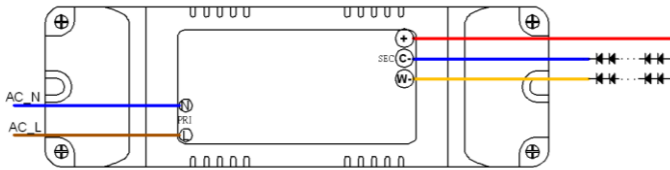

- Two channels output, common anode, C- for cool white LED, W- for warm white LED
- Suggestion 1: make all connection as short as possible to ensure good EMC behavior.
- Suggestion 2: use 0.75-1.0mm<sup>2</sup> wire, strip length 3-5mm

### 6.2 Installation

- Heat dissipation must be considered before installation.
- Metal shielding is not allowed without putting the antenna out.
- Keep the drivers as far as possible away from electromagnetic interference in the surrounding environment to ensure RF controlling behavior.
- Make sure to keep mains off while installation.

## 9. All models and specifications

T5151R is the general series number, it includes the following models:

Model Number	Input Voltage/V	Max Input Current/mA	Input Power/W	Output Voltage/V	Output Current/mA	Max Output Power/W	Max Output Voltage/V
T5151R -0150	220AC	33	7.2	36V	150	5.4	50
T5151R -0200	220AC	44	9.6	36V	200	7.2	50
T5151R -0250	220AC	55	12	36V	250	9	50
T5151R -0300	220AC	65	14.4	36V	300	10.8	50
T5151R -0350	220AC	76	16.8	36V	350	12.6	50

## 7. Dimension

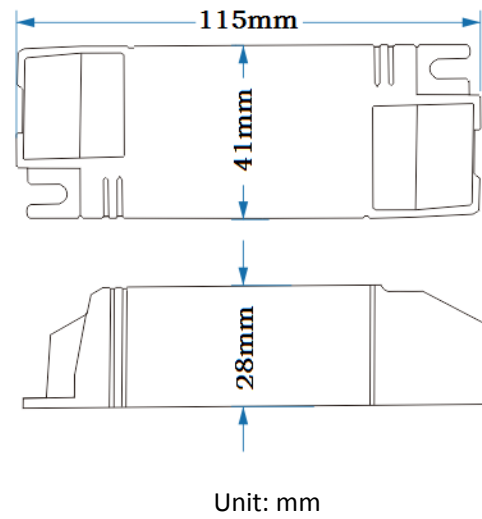

## 8. Packing data

Weight per PCS	70g
Quantity/Carton	100PCS
Weight per Carton	8KG
Size of Carton	35cm*30cm*22cm

The packing data is for reference, the exact data subjects to the packing requirement of customers.

10. System Structure

### RF-2.4G Lighting System

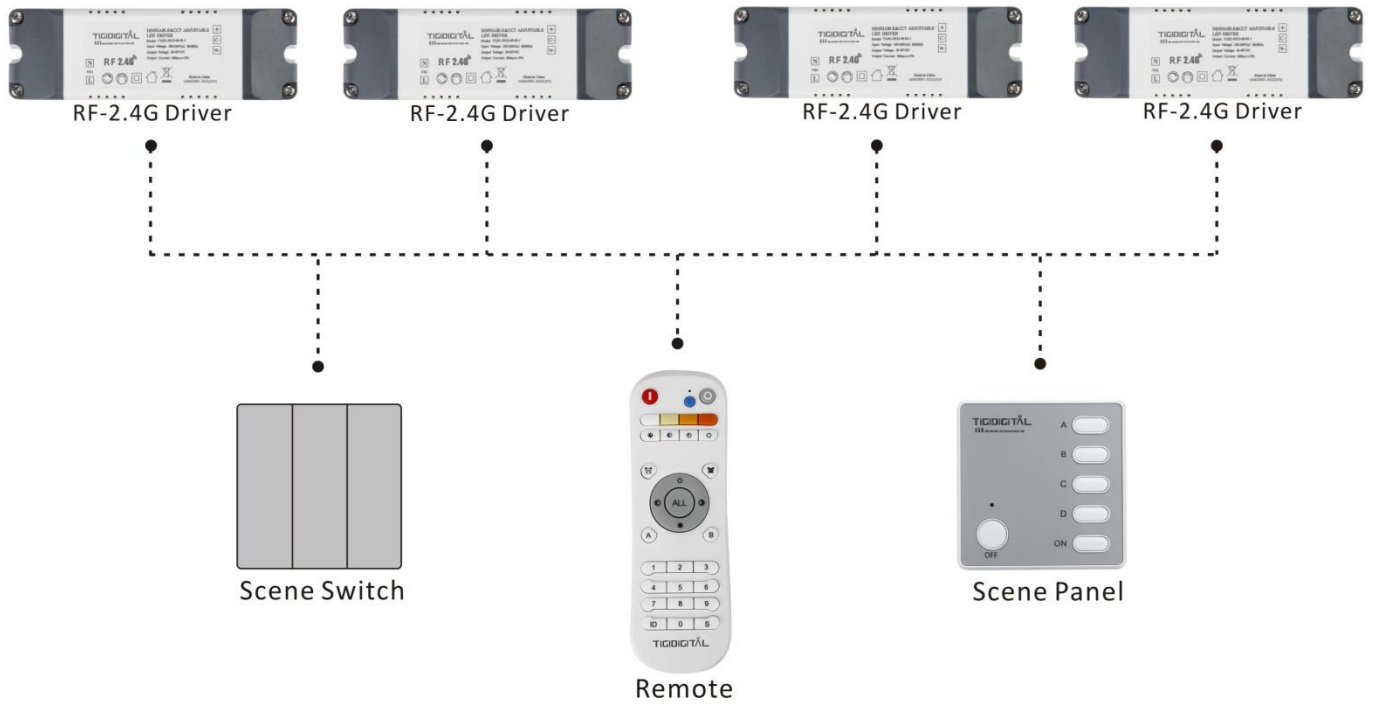

**Note**

- TIGI reserves the right to make changes or corrections to the products at any time without notice. Customers should verify the datasheets are current and complete before placing order.
- The improvement of our products is endless , we will be always trying our best to provide better products for our customers.
- All the contents above are only for reference , The actual parameters are based on the approval sheet of our company.