

MODEL: C2605

NVMe M.2 SSD ENCLOSURE

USB 3.1 Gen 2 Type-C To M.2 NVMe SSD

www.ineo-usa.com

Package Contents

C2605	M.2 NVMe to USB 3.1 Gen 2
Type C to Type A Cable	Yes
Type C Adapter	Yes
Heat Sink	Yes
Thermal Pad	Yes
Screw Kit	ScrewDriver x 1, Screws x 1
Warranty Card	Yes
User Manual	Yes

Connect properly

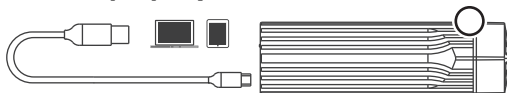

Plug in the type C connector to C2605 enclosure and plug in the type A connector to computer.

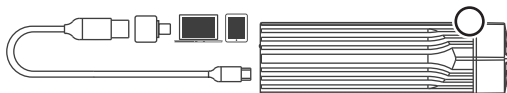

Plug in the type C connector to C2605 enclosure and use the type C adapter to connect to the computer.

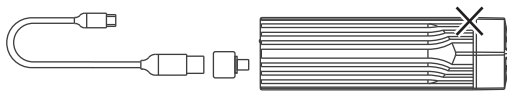

Using the Type C adapter between the enclosure and the cable is strictly prohibited.

Write-protect Switch

Write Protection Switch Lock secures the flash drive, prevents virus, intrusion, data tampering and accidental deletion

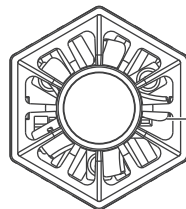
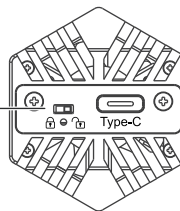

Fan sleep mode

The full-time cooling fan automatically sleeps as the SSD stops reading and writing for 10 minutes.

M.2 NVMe SSD Drive Installation

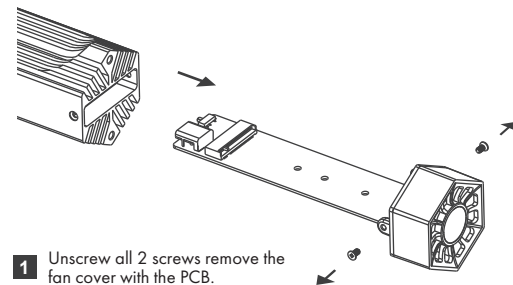

1 Unscrew all 2 screws remove the fan cover with the PCB.

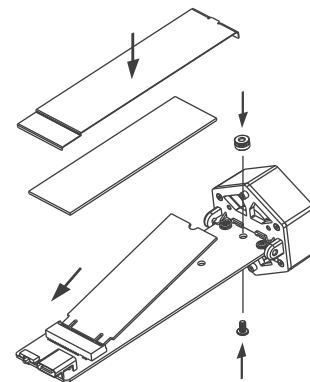

2 Insert the M.2 SSD, lock the screw to secure M.2 SSD, then attach thermal silicon pad.

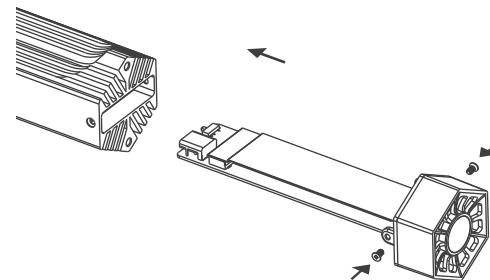

3 Put the PCB back into the aluminum case and lock the screws, Installation is complete.